

winonaLED

V-Line GEN4

LINEAR LIGHTING SYSTEM

Type:

V-Line Gen4 is a high performance linear LED luminaire with a small profile suitable for illumination of displays, signage, cabinets, and other small areas.

Construction: Extruded aluminum body with molded endcaps. Extruded acrylic optic is UV resistant.

Finish: Black anodized only. This product is not available in a painted finish. Painting this product will void all warranties.

Dimming: True 0-100% dimming is available with exclusive LightLink dimming system interface which is compatible with both 0V-10V sink and source-type dimmers.

Available Mounts: Both fixed and adjustable mounts are available. Mounts have been engineered to provide precise aiming and installation flexibility.

Power Requirements: V-Line Gen4 is powered by a non-magnetic 24V DC power supply sized according to the installation. Power consumption is approximately 4W per linear foot.

Wiring: V-Line Gen4 is supplied with an exclusive 4-way endcap that allows the installer to run wiring out the left, right, bottom, or end of the luminaire. A 72" long plenum-rated cable is standard. See third page for additional wiring information.

Dry, Damp, and Wet Locations

Four possible wire locations - Left, Right, Side, and Bottom

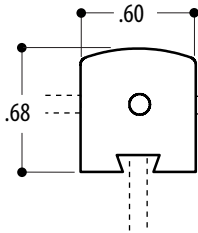

(Shown full size)

Project Name:

Qty:

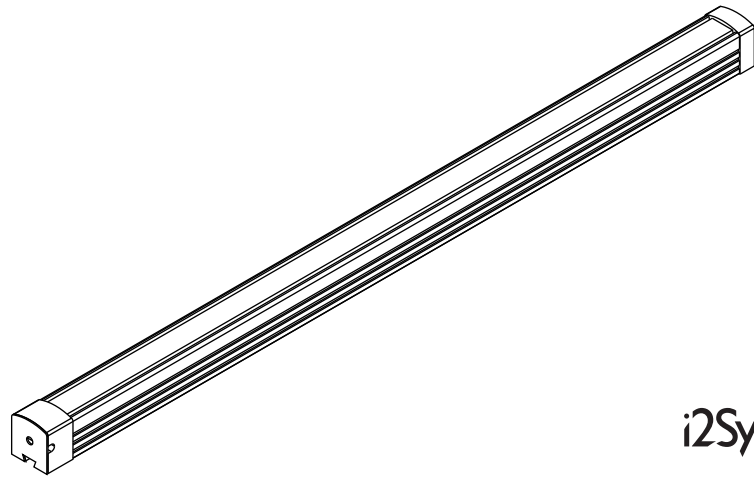

i2Systems
enabLED.

Available Lengths: (12", 18", 24", 36", 48")

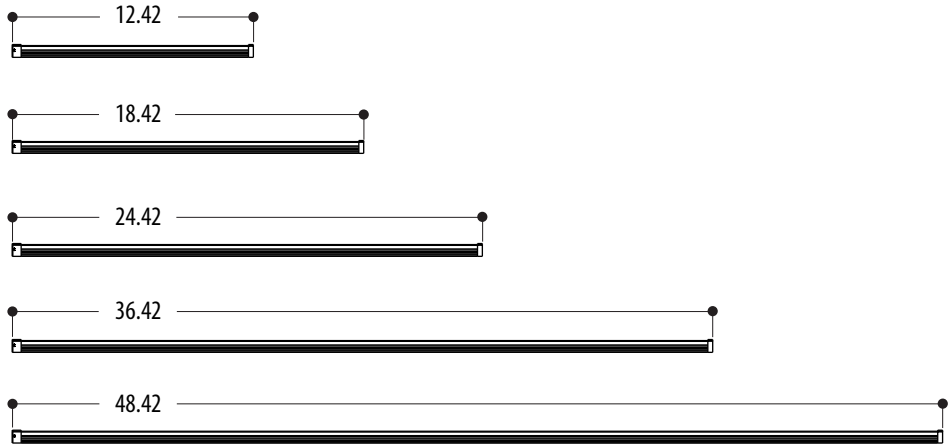

Wire Codes:

RED to power supply 24V positive
BLACK to power supply ground



LED **VL4** **65** **LED CODE** **VOLTAGE SUPPLY** **MOUNT** **BLK** **X** **SPECIAL**

SOURCE MODEL UNIT LENGTH OR TOTAL RUN LENGTH (if known) BEAM ANGLE FINISH OPTIONS

VL4 = V-Line GEN4

UNIT LENGTH OR TOTAL RUN LENGTH IN FEET

12 = 12 INCH
18 = 18 INCH
24 = 24 INCH
36 = 36 INCH
48 = 48 INCH

NOTE: When building a run, standard length fixtures may be used in combination.

65 = 65° SYMMETRIC

CODE	COLOR
001	WARM WHITE 3000K
002	COOL WHITE 6200K

NON-DIMMING
ND24V = 24V DC

DIMMING
DM24V = 24V DC LightLink dimming system interface maximum 16 feet per LightLink, one LightLink per dimming zone.

ADJ = ADJUSTABLE
FIX = FIXED

BLK = BLACK ANODIZED
Product cannot be painted. Painting will void warranty.

STD = STANDARD
MOD = MODIFIED

X = NO OPTION

Modifications: (if any) _____



Revision 2/4/10

GEN4 ADJUSTABLE MOUNT (NOT TO SCALE)

304 stainless steel construction

Black oxide finish

Hole for #8 fastener (by others)

Button head adjustment screw
- Use 7/64" hex wrench

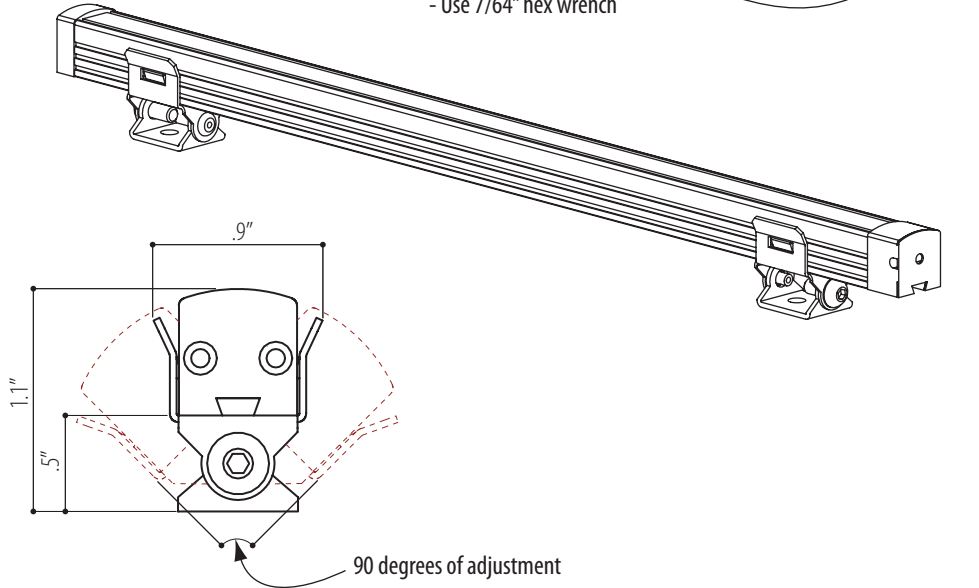

The Gen4 Adjustable Mount provides 90 degrees of adjustment and is fastened to the mounting surface with a single #8 screw (by others).

Manufactured of 304 stainless steel with black oxide finish.

Installation Instructions:

1. The adjustable mounts can be located anywhere along the length of the Gen4 fixture however it is best if they are located within 2" of each end.
2. Layout the location of the mounts and mark hole locations for a #8 fastener (by others) at each mount location.
3. Fasten mounts to surface with appropriate fastener and snug adjustment screws.
4. Center the Gen4 and firmly snap into place. The tabs on the adjustable mount engage the second set of heatsink fins of the Gen4 - be sure the fixture bottoms on the mount.
5. Refer to wiring page for electrical hook up for dimming and non-dimming installations.
6. Once fixtures are wired and illuminated, make final aiming adjustment and tighten down adjustment screws.

GEN4 FIXED MOUNT (NOT TO SCALE)

304 stainless steel construction

Black oxide finish

Hole for #8 fastener (by others)

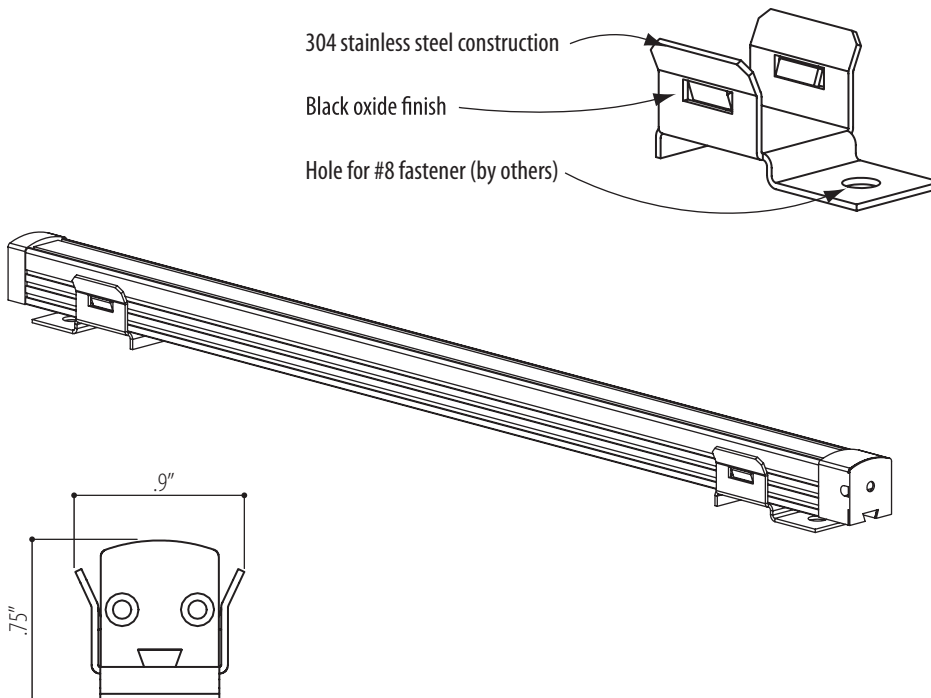

The Gen4 fixed mount is fastened to the mounting surface with a single #8 screw (by others).

Manufactured of 304 stainless steel with black oxide finish.

Installation Instructions:

1. The fixed mounts can be located anywhere along the length of the Gen4 fixture however it is best if they are located within 2" of each end.
2. Layout the location of the mounts and mark hole locations for a #8 fastener (by others) at each mount location.
3. Fasten mounts to surface with appropriate fastener.
4. Center the Gen4 and firmly snap into place. The tabs on the adjustable mount engage the second set of heatsink fins of the Gen4 - be sure the fixture bottoms on the mount.
5. Refer to wiring page for electrical hook up for dimming and non-dimming installations.

V-line Gen4 can be powered by any non-magnetic 24V DC power supply. Do not connect directly to line voltage under any circumstance.

Connection to line voltage will permanently damage internal components and void manufacturer's warranty.

The 24V DC power supply must be capable of supplying adequate power to avoid permanent damage to the power supply and Gen4 fixtures.

Each linear foot of Gen4 consumes 4W of power. Multiply total footage by 4W to determine size of power supply required. Choose a power supply with adequate capacity. Total load should not exceed 85% of power supply's rated output at 24V DC.

NON-DIMMING INSTALLATIONS

Gen4 luminaires are wired in parallel to a 24V DC power supply.

Create a pair of feed wires using 16-gauge or larger wire. Use of the 12-gauge wire is recommended for remote power supply installations.

Connect Gen4 **RED** wire to power supply **+24V DC**

Connect Gen4 **BLACK** wire to power supply **COMMON**

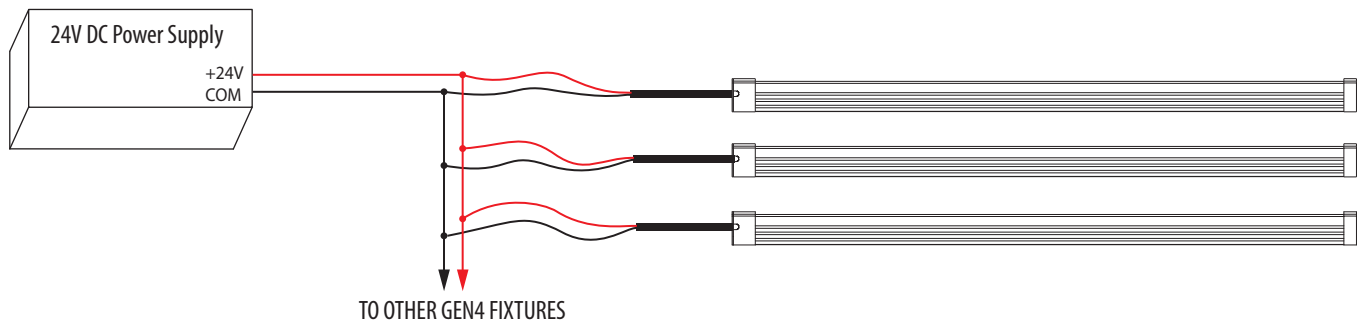

DIMMING INSTALLATIONS

All dimming installations require the use of the LightLink dimming module which is spliced inline with the common wire from the 24V DC power supply. The LightLink module will accept any 0-10V dimming signal input (source or sink) from any dimming control system as well as PWM input and analog input from room sensors or other devices. Refer to LightLink documentation for detailed installation and operating instructions.

Mount the LightLink module close to and feed its power from the same 24V DC power supply used for the Gen4 luminaires. On installations requiring more than one power supply, a LightLink module must be used for each supply. Multiple LightLink modules may be connected to the same power supply. Use minimum of 12-gauge wire for remote power supply installations.

Connect Gen4 **RED** wire to power supply **+24V DC**.

Connect Gen4 **BLACK** wire to LightLink Output marked **"DIM"**.

Connect LightLink Output marked **"COMMON"** to power supply **COMMON**.

Connect 1 to 10V dimmer **INPUT** wire to LightLink Control Input marked **"+10V SOURCE"**.

Connect 1 to 10V dimmer **COMMON** wire to LightLink Control Input marked **"COMMON"**.

Connect power supply **COMMON** to LightLink **"Input Power 12/24V -DC"**.

Connect power supply **+24V DC** to LightLink **"Input Power 12/24V +DC"**.

Ensure **ORANGE** program plug is installed.

